

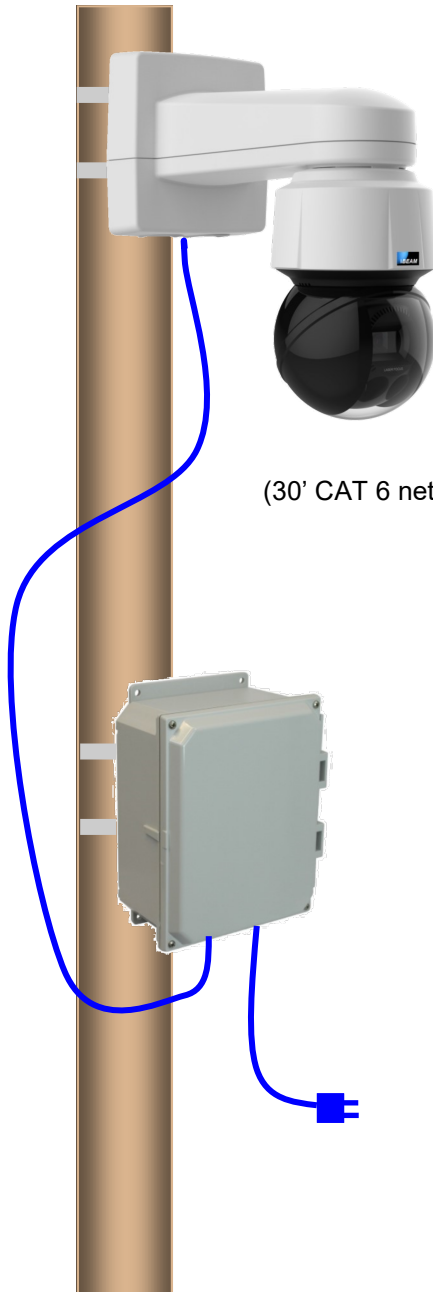

## iBEAM® OnSite PTZ 4K Construction Camera with Cellular Communication (120V AC) INSTALLATION INSTRUCTIONS



(30' CAT 6 network cable provided)

1. Attach camera to your pole using the provided straps.

2. Attach the communication box to your pole using the provided straps.

3. Feed the camera's network cable through the cable gland at the bottom of the communication box .

Plug the network cable into the power supply's "camera" port.

Tighten the nut on cable gland.

4. Plug the unit into 120V AC power.

5. View your camera by logging in at [www.ibeamsystems.com](http://www.ibeamsystems.com)

**Call the iBEAM Support Team at 1.800.403.0688 to verify installation  
and to set your camera views.**



## iBEAM® OnSite PTZ 4K Construction Camera with Cellular Communication (12V) INSTALLATION INSTRUCTIONS

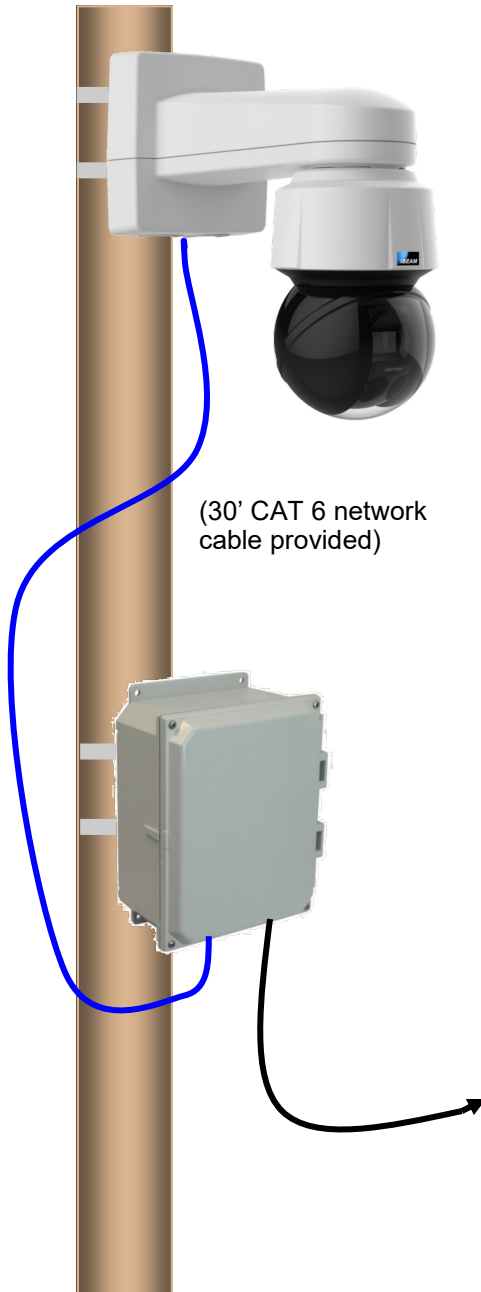

1. Attach camera to your pole using the provided straps.

2. Attach the communication box to your pole using the provided straps.

3. Feed the camera's network cable through the cable gland at the bottom of the communication box .

Plug the network cable into the power supply's "camera" port.

Tighten the nut on cable gland.

4. Plug the unit into 12V power source (solar or battery kit — see separate instructions).

5. View your camera by logging in at [www.ibeamsystems.com](http://www.ibeamsystems.com).

**Call the iBEAM Support Team at 1.800.403.0688 to verify installation  
and to set your camera views.**



# iBEAM CONSTRUCTION CAMERAS

## iBEAM® OnSite PTZ 4K Construction Camera with Ethernet Communication INSTALLATION DIAGRAM

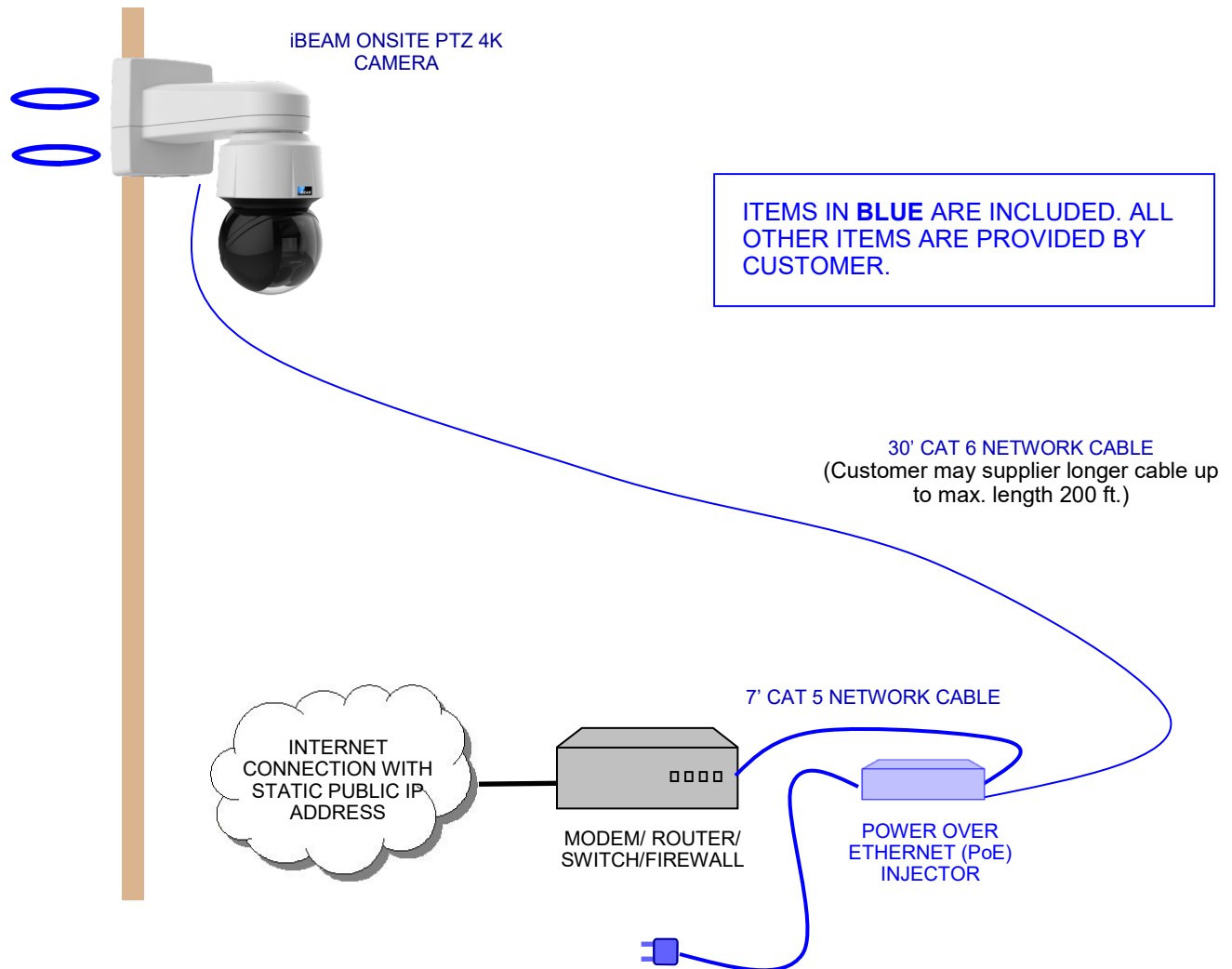

**\*\*YOUR NETWORK MAY VARY. CONSULT YOUR NETWORK ADMINISTRATOR.**

Your iBEAM OnSite PTZ 4K Construction Camera system has been programmed with the IP addresses you provided:

OnSite PTZ 4K Camera: \_\_\_\_\_

Your camera web page is: [www.ibeamsystems.com/camera/](http://www.ibeamsystems.com/camera/)\_\_\_\_\_

800.403.0688

[www.ibeamsystems.com](http://www.ibeamsystems.com)



## **iBEAM® OnSite PTZ 4K Construction Camera with Ethernet Communication** INSTALLATION INSTRUCTIONS

### **BEFORE YOU BEGIN**

1. READ THESE INSTRUCTIONS.
2. TEST THE CAMERA ON THE GROUND. Plug in the camera and confirm proper operation before you install the camera on your mounting surface.

### **Getting Started**

Remove all components from shipping box.

### **Install the Camera**

Attach the camera to the mounting surface (pole or wall) using the supplied hardware.

Connect network cable from the camera to the Power Over Ethernet injector where indicated (to camera).

Connect network cable from your modem/router to the Power Over Ethernet injector where indicated (to network).

Plug the Power Over Ethernet injector into 120V power.

*See manufacturer's Installation Guides for detailed instructions.*

### **Configure your Network**

Your network must be configured to allow outside traffic to the camera. The most common method for this is to use port forwarding on your network's router to forward all outside requests on port 80 to the camera's network IP address. See other side for the camera's network IP addresses.

SEE INSTALLATION DIAGRAM ON PREVIOUS PAGE